

# B-53 B-54

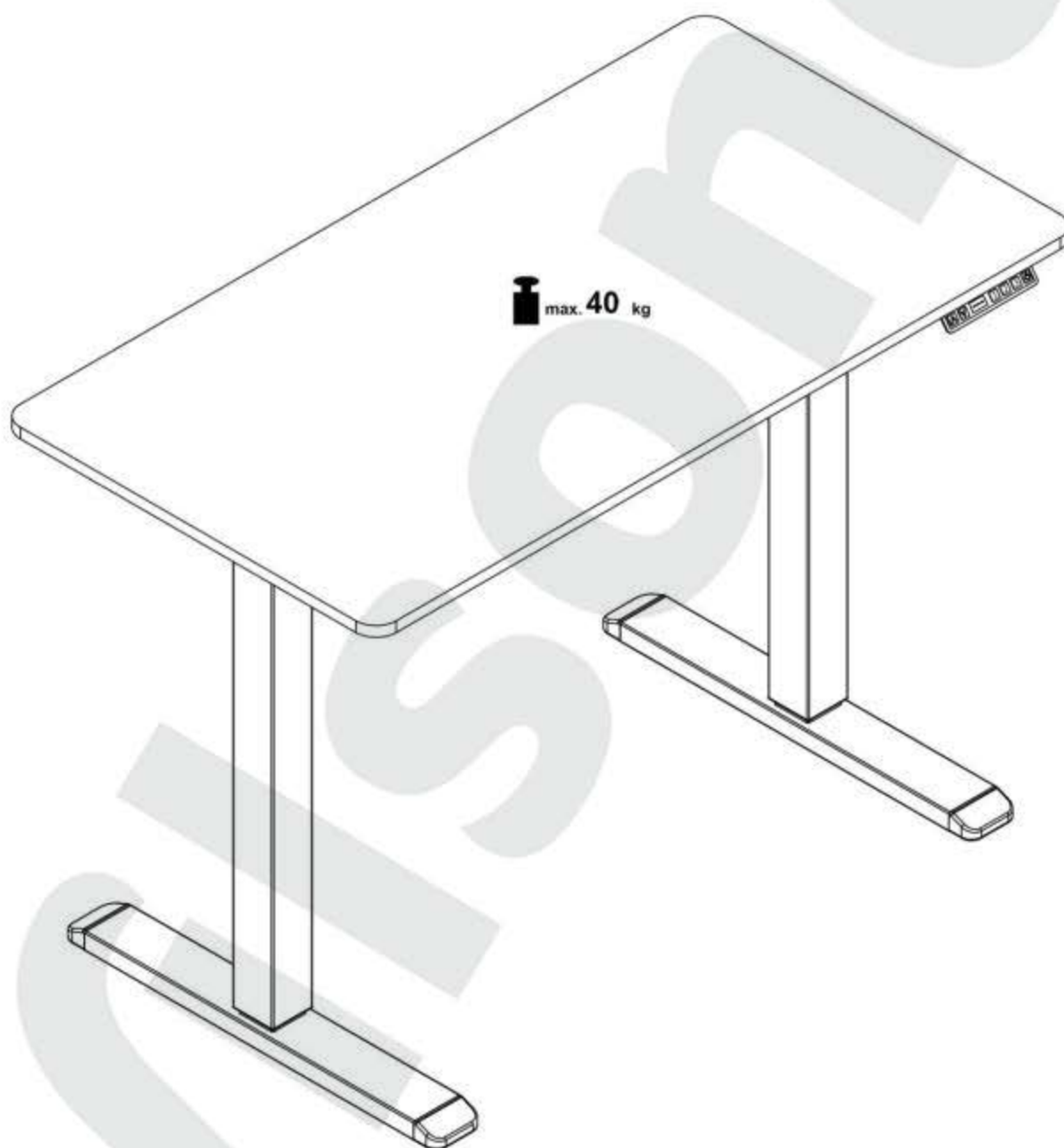

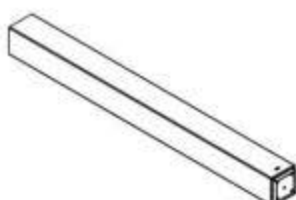

Ax1



Bx1

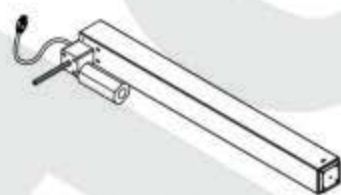

Cx1



Dx1

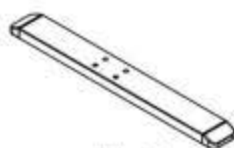

Ex2



Fx1



Gx1



Hx1

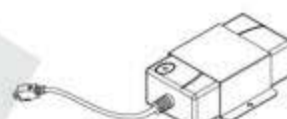

Ix1



Jx8



Kx14



Lx14



Mx6



Nx1



Ox4



Px4



Qx1



Rx1



Sx1



Tx1



Ux1

# 1

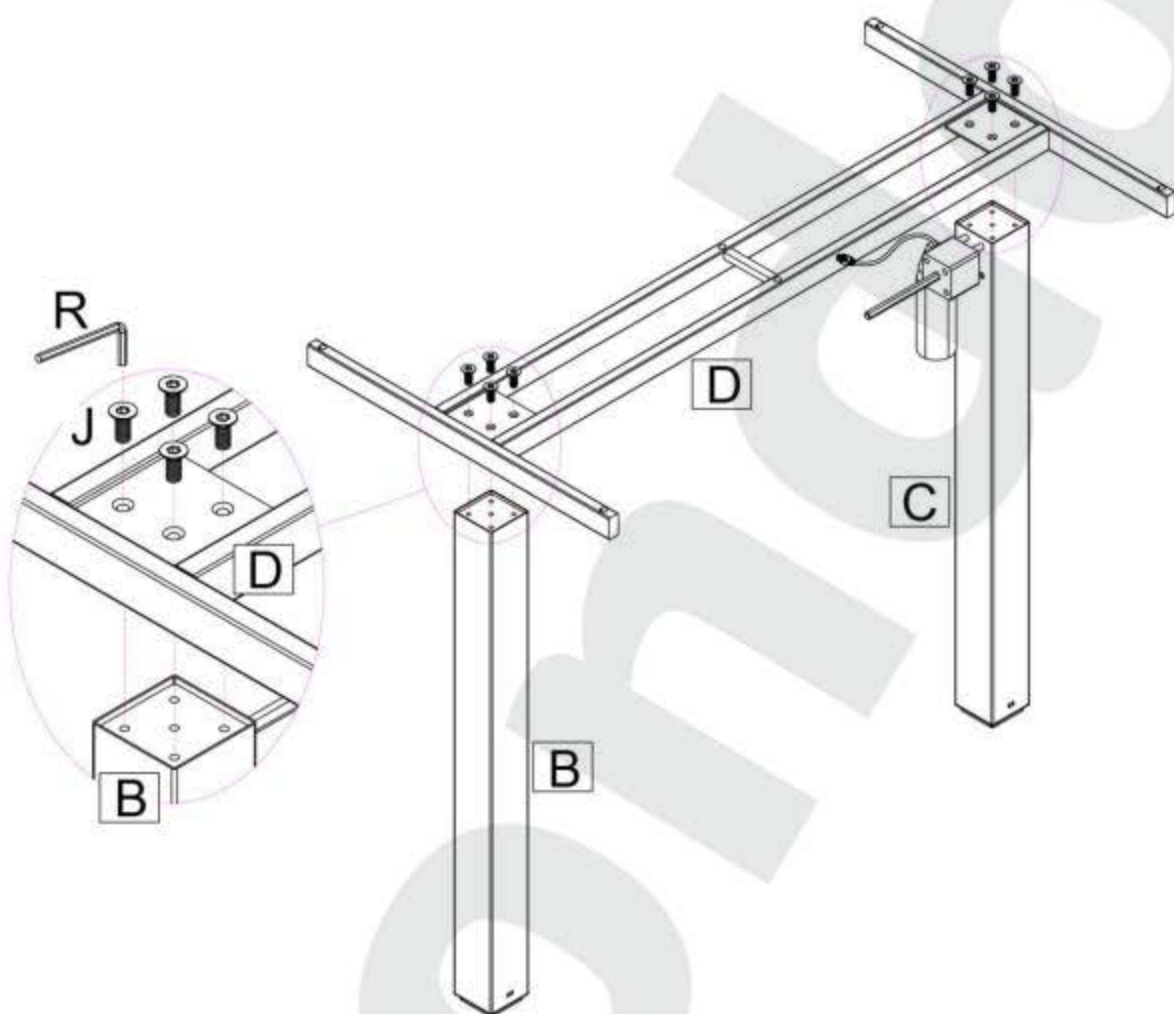

J



R



# 2

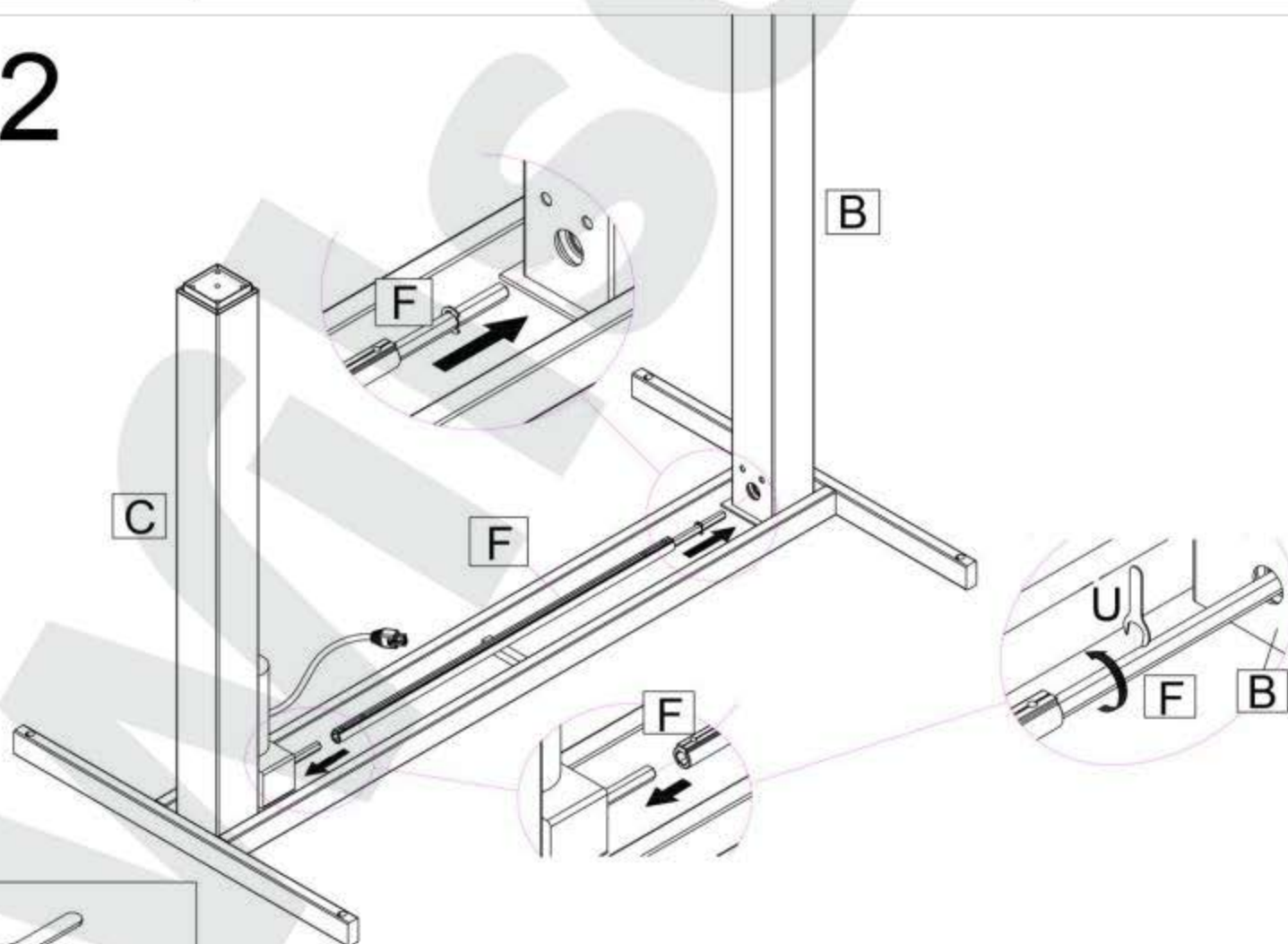

U



# 3

# 3

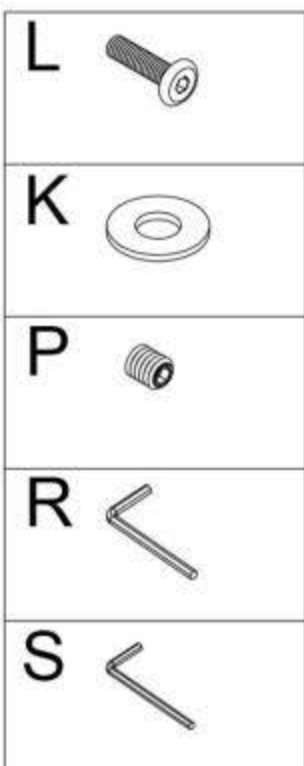
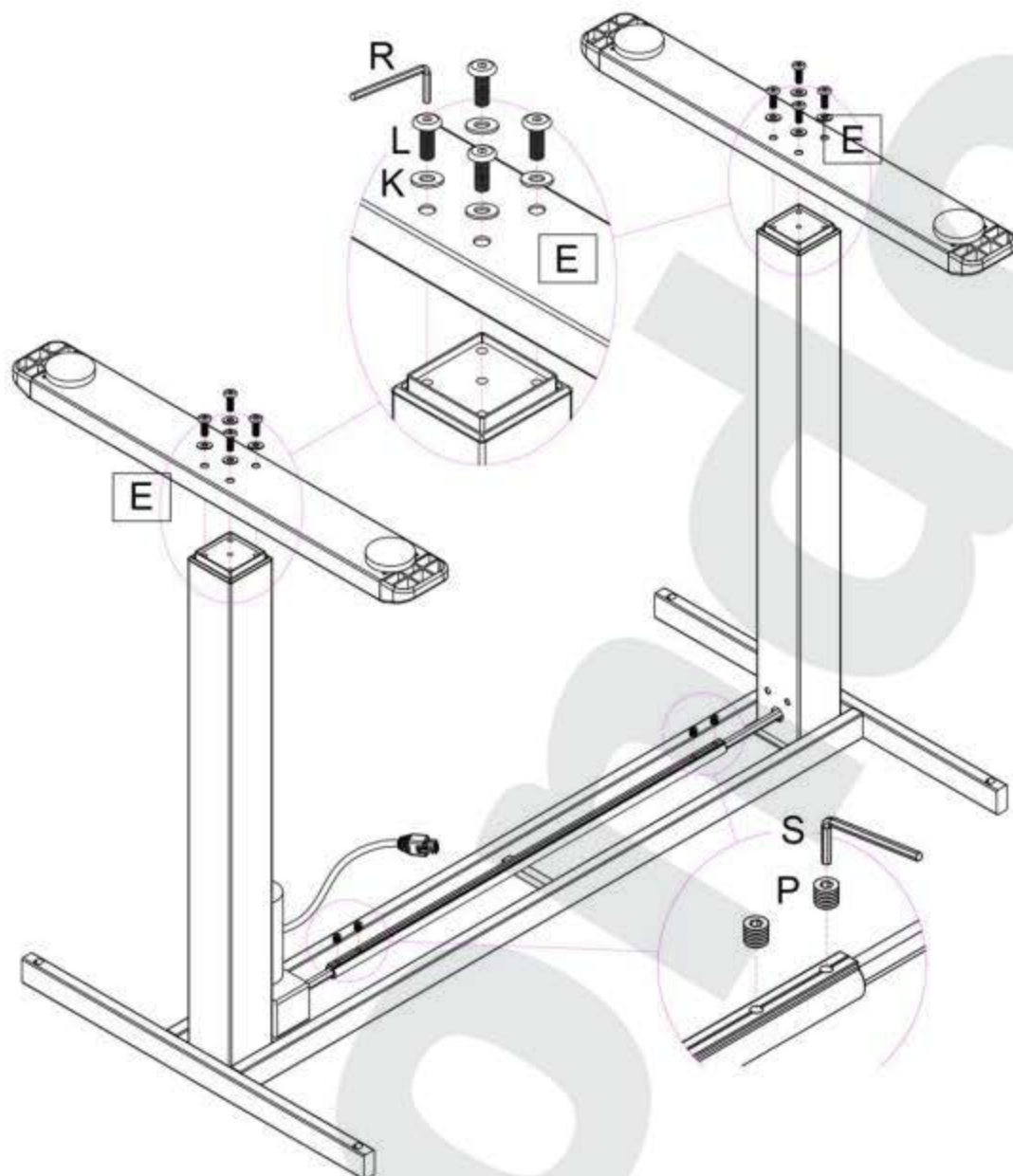

# 4

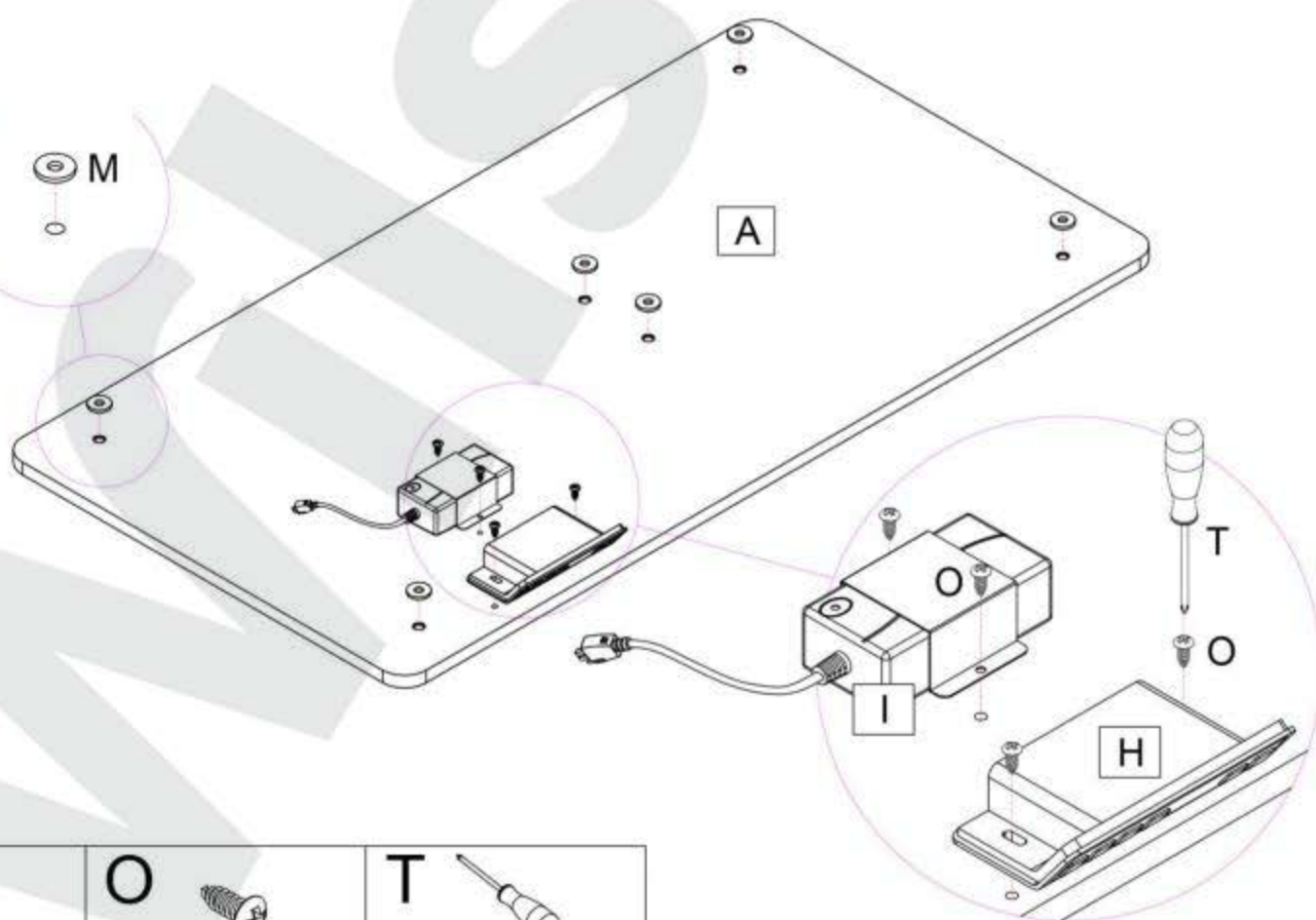

# 4



# 5

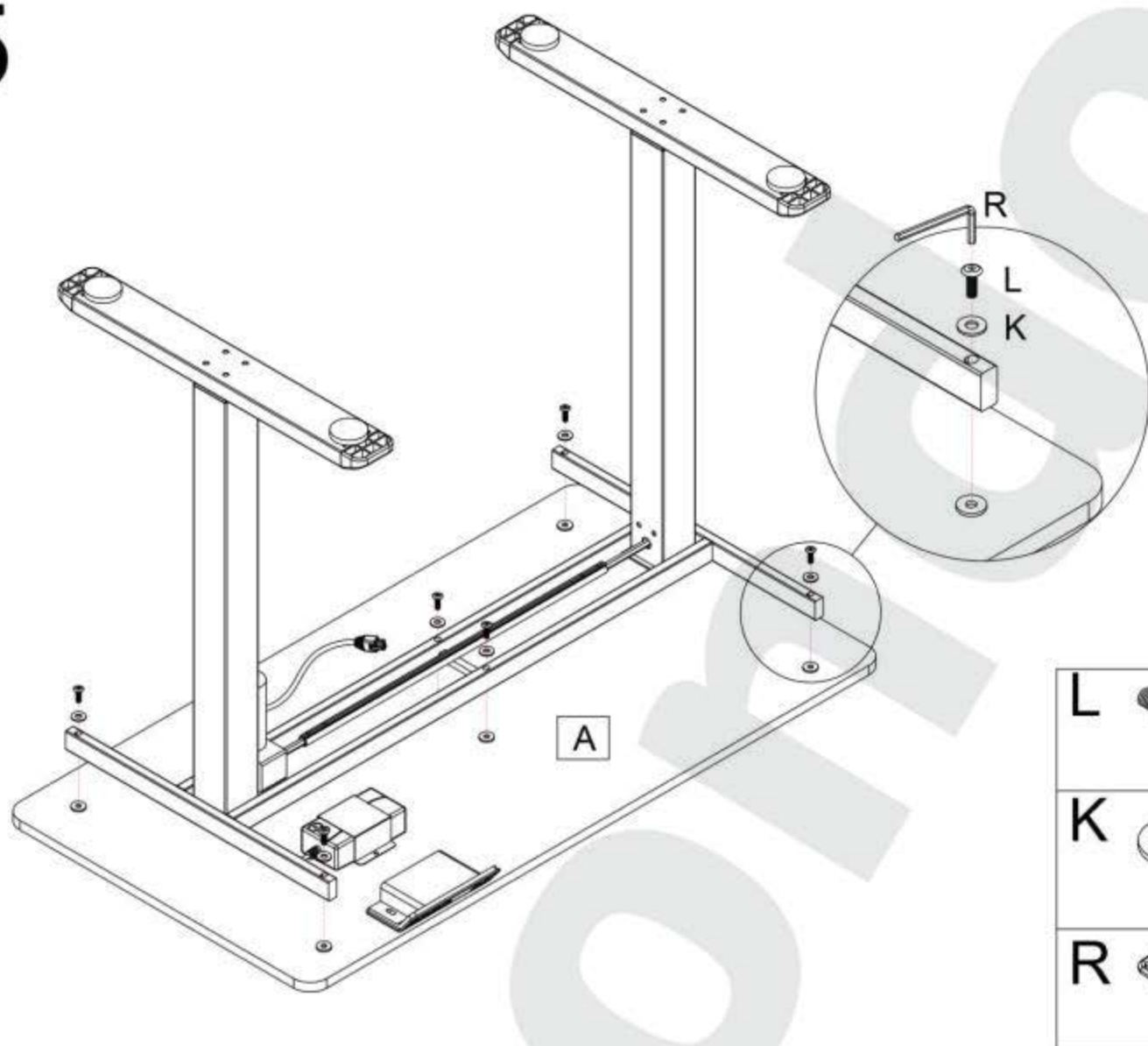

# 6

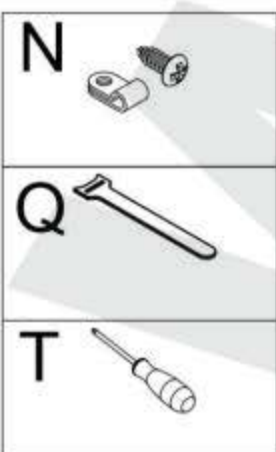
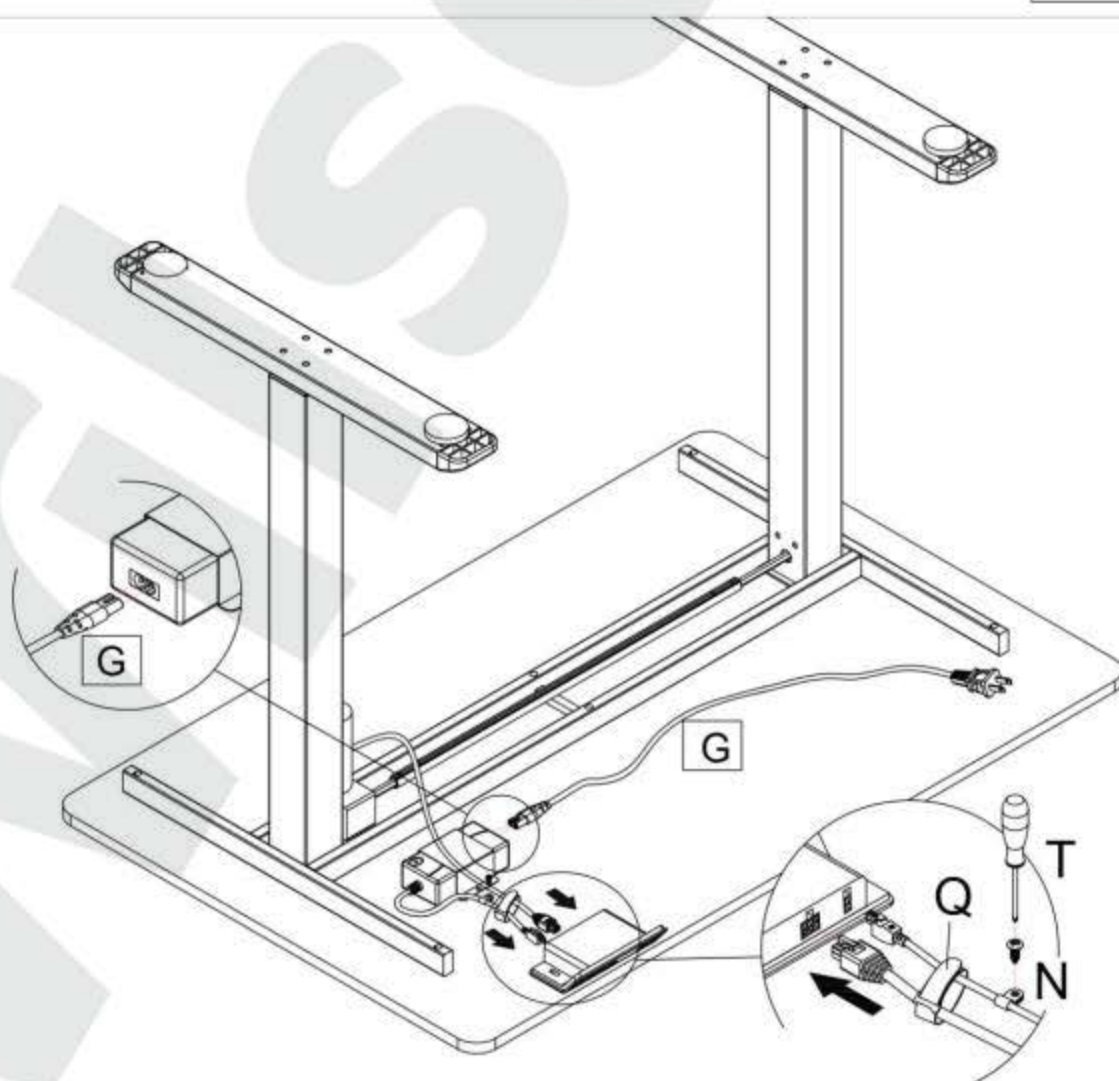

# 5

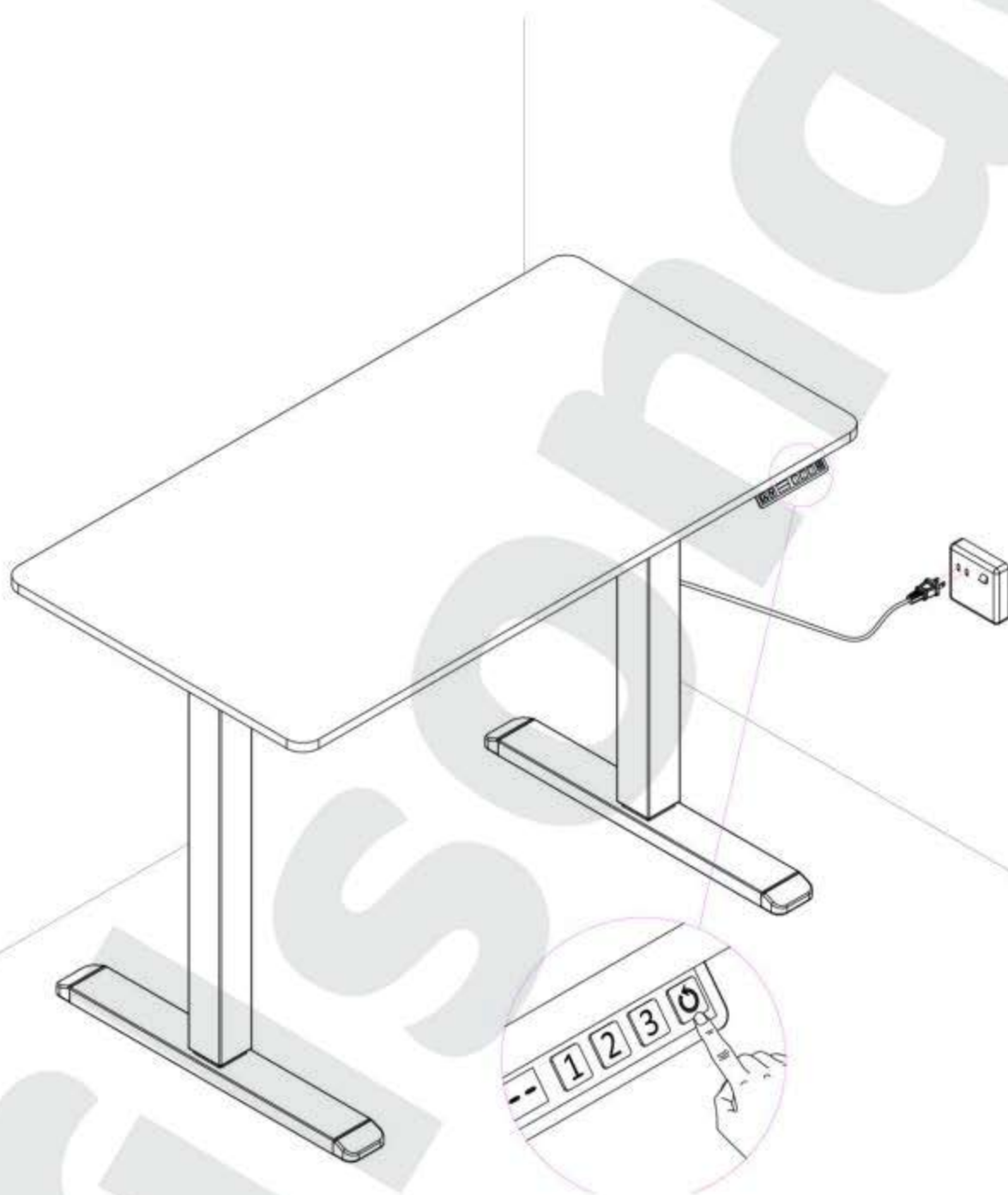

# Operating instruction

## Buttons introduction

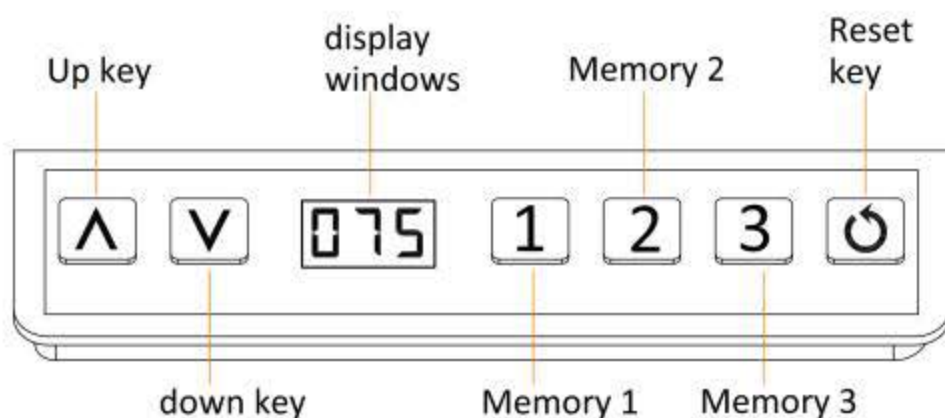

### Display Windows

**075** = Height

**L** = Locked

**E \* \*** = See Trouble Shooting

## Up and down operation

- ◆ Press and hold the **▲** key and the desktop will run up automatically. When you release it, then it will stop.
- ◆ Press and hold the **▼** key and the desktop will automatically run down. When you release it, then it will stop.
- ◆ Press the **▲** key or **▼** key, and the desktop will run a short distance to realize the click.

## Highly memorized functional operation

- ◆ Location storage: 3 memory points can be memory. The storage method is as follows: when it reaches a specific point, long press **1 / 2 / 3** key until the digit flashes, and the current height is successfully memory to the corresponding label.
- ◆ Memory position operation: press **1 / 2 / 3** key, the display flashes the height of memory position for 2s, the desktop automatically runs to the height of memory position, in operation, any key can stop running.

## Minimum limit setting

- ◆ The system supports limiting the minimum height of the desktop. The operation method is to let the desktop run to the position to be set. At the same time, hold down the **↻ + ▼** key for 5s. displaying **-d0** to indicate successful memory of the highest position. When running to the lowest point, the display shows **-L0**.
- ◆ Cancel the storage height,  
Method 1: mechanical zero reset, the system automatically cancel.  
Method 2: Let the desktop run to the lowest point, the monitor displays windows **-L0**, while holding the **↻ + ▼** key for 5s, **-d0** indicates successful cancellation.

## Maximum limit setting

- ◆ The system supports limiting the maximum height of the desktop. The operation method is to let the desktop run to the position to be set. At the same time, hold down the **↻ + ▲** keys for 5s. displaying **-uP** to indicate successful memory of the highest position. When running to the highest point, the monitor shows **-H1**.
- ◆ Cancel the storage height,  
Method 1: mechanical zero reset, the system automatically cancel.  
Method 2: Let the desktop run to the highest point, the monitor displays windows **-H1**, while holding down the **↻ + ▲** keys for 5s, **-uP** indicates successful cancellation.





## Initial reset

- ◆ Long press  for 3 seconds, release the button after the display --- blinks, and the desktop will automatically run down to the lowest position and then up for a short distance and stop, the reset process is finished.

## Child lock function

- ◆ Lock: Hold down  $\wedge + \vee + 2$  key for 5s at the same time. When the display windows displays  $\text{L}$ , it indicates that the controller buttons is locked and cannot be operation.
- ◆ Unlock: Hold down the  $\wedge + \vee + 2$  key for 5s at the same time. When the display windows changes from  $\text{L}$  to a normal number, it indicates that the lifting system controller buttons has been unlocked.

## Standing reminder (countdown mode)

- ◆ Countdown time: Provide 3 levels of time,  $\text{F30}$  = 30 minutes,  $\text{F45}$  = 45 minutes,  $\text{F60}$  = 60 minutes.
- ◆ Start countdown: Press  the display windows to display  $\text{F30}/\text{F45}/\text{F60}$  at a time, choose a time and start in the countdown period.
- ◆ Exit countdown: 1. Short press , the display windows will display the number.  
2. When the countdown time is up, the display windows will blink  $\text{cHr}$  for 1 minute. Press any key to stop the timing and exit.  
3. If there is no operation, the time will be automatically quit after being reminded for 3 consecutive times at an interval of 5 minutes.

## Restore factory Settings

- ◆ Method: Hold down the button  $\wedge + \vee + 3$  for 5s at the same time. The displays windows display  $\text{cLr}$ , indicating that the parameter is successfully restored.

## Error code table

Display status	Explain	Process mode
<b>E01</b>	Motor not connected	Press the up button or down button again. It still exists. Please check the motor connect line
<b>E02</b>	Motor overcurrent	Press the up button or down button again. It still exists. Please replace the motor or reduce the load
<b>E03</b>	Hall failure of motor	Press the up button or down button again, it still exists. Please check the connection or replace motor
<b>E04</b>	Abnormal main power supply	Unable to eliminate after power, replace the power supply
<b>E05</b>	Motor current is abnormal	Unable to eliminate after power loss need to return to the factory
<b>E06</b>	The power component of the motor is broken	Unable to eliminate after power loss need to return to the factory
<b>E09</b>	Motor is stuck	Press the up key or down key again, it still exists, please replace motor or reduce the load
<b>hoF</b>	Overtemperature protection	Wait for the temperature to drop, run for 2 minutes, stop for 18 minutes
<b>r5F</b>	Illegal power failure	Load reduction



## Use and maintenance advice

1. Place the furniture stably and avoid tilting, which will cause the legs of the furniture to break or the connection parts to become loose.
2. Before using the new furniture, put it in a ventilated place for half a month, which can eliminate the odor of the new furniture.
3. Do not push hard objects directly on the surface of the furniture to avoid scratching the surface of furniture. Heavier or harder items should be placed on the surface of the furniture with soft decorative tablecloth or felt pads to achieve protective effect.
4. Educate children not to play near the sharp corners of glass on the furniture to avoid accidental injury to the human body and furniture.
5. Flammable and oxidizing articles come into direct contact with the surface of furniture, which may cause damage to the paint decoration of furniture.
6. When dragging the drawer, use appropriate force. It is forbidden to open and close violently, causing the connection to loosen.

## Disposal



If disposal of this product becomes necessary, please do this in an environmentally responsible way. Contact your local government office or authority for suitable disposal or recycling options in your local area. Do not dispose of this product, or its components, with your general domestic waste.